



**DURELO**  
TOUGHEST TOOLS



# TOOLS & EQUIPMENTS



# 1

## LUBRICATION EQUIPMENTS

AIR OPERATED GREASE RATIO PUMP 50:1	01
GREASE BUCKET PUMP	2-3
LEVER GREASE GUN – PROFESSIONAL	04
MINI LEVER GREASE GUN	04
LEVER GREASE GUN – STANDARD	04
ROTARY BARREL PUMP	05
FOOT OPERATED PUMP	05
GREASE GUN HOSES	06
GREASE GUN STEEL EXTENSION	06
HYDRAULIC COUPLERS	06
GREASE FITTINGS	07
OIL CANS	07

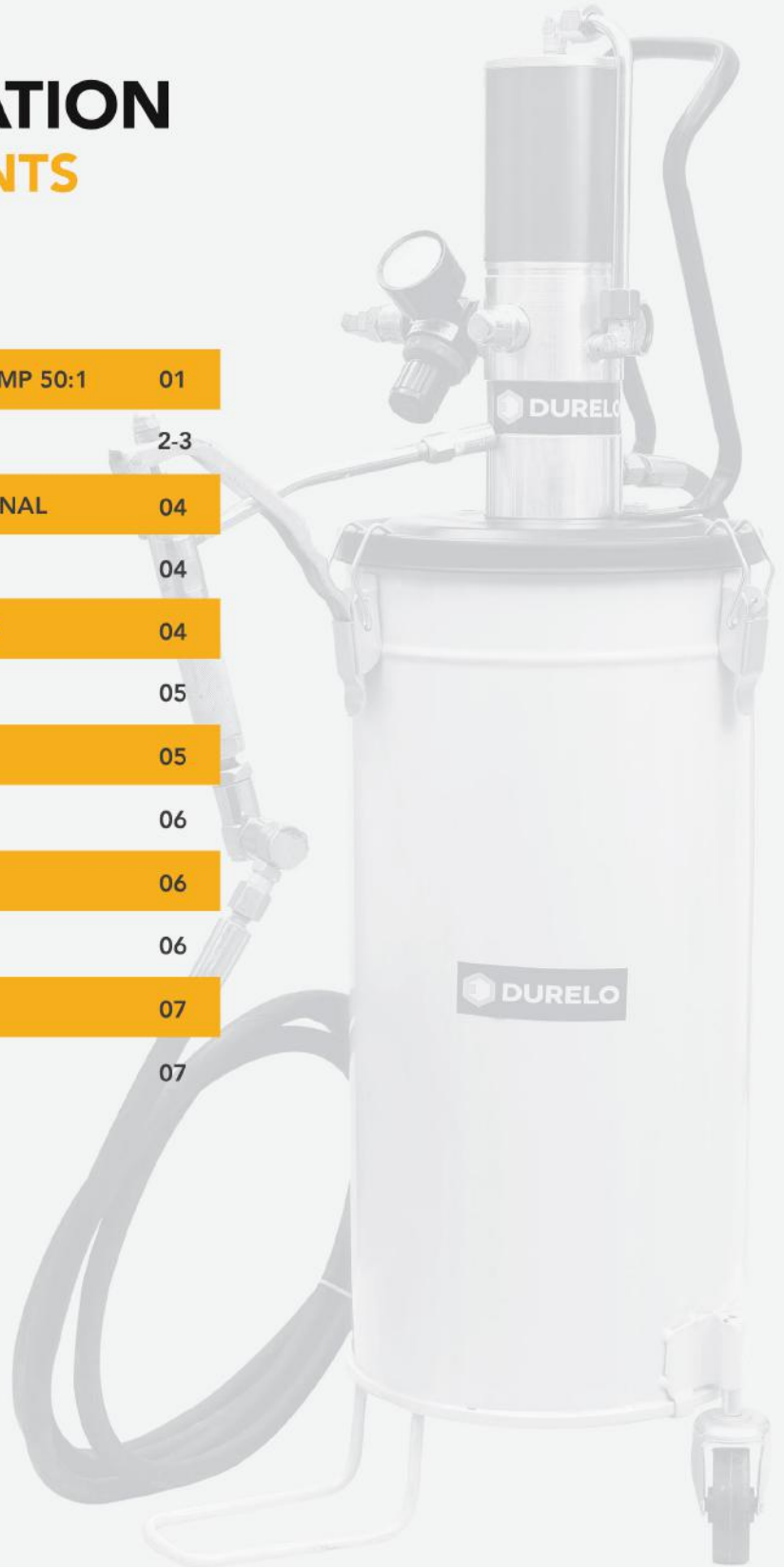

## 2 HAND TOOLS

COMBINATION PLIER WITH SIDE CUTTER	09
SIDE CUTTING PLIER	09
LONG NOSE PLIER	10
WATER PUMP PLIER BOX JOINT TYPE (WITH DIP INSULATION)	10
WATER PUMP PLIER SLIP JOINT TYPE	11
VICE GRIP PLIER	11
ADJUSTABLE WRENCHES	12
PIPE WRENCH STILSON PATTERN	12
FILTER WRENCH BELT TYPE	13
FILTER WRENCH BELT TYPE	13
12.5MM (1/2") DRIVE ALLEN SOCKETS	15
12.5MM (1/2") DRIVE TORX BIT SOCKETS	15
12.5MM (1/2") DRIVE E-SOCKETS	16
12.5MM (1/2") DRIVE HEX & BI-HEX SOCKET SET	16
6.35MM (1/4") DRIVE HEX SOCKET SET	17
19MM (3/4") DRIVE HEX & BI-HEX SOCKET SET	17
19MM (3/4") DRIVE HEX & BI-HEX SOCKETS	18
12.5MM (1/2") DRIVE HEX & BI-HEX SOCKETS	19
12.5MM (1/2") DRIVE HEX & BI-HEX LONG SOCKETS	20
12.5MM (1/2") DRIVE SPARK PLUG SOCKETS	20
EXTENSION BAR	21
L-HANDLE	21



REVERSIBLE RATCHET HANDLE	22
SLIDING T-HANDLE	22
UNIVERSAL JOINT	22
SOCKET ADAPTORS	23
SWIVEL HANDLE	23
SPEED BRACE	23
DOUBLE OPEN END SPANNERS	24
DOUBLE OPEN END JUMBO SPANNERS	25
DOUBLE OPEN END SPANNER SETS	26
BI HEXAGONAL RING SPANNERS - SHALLOW OFFSET	27
RING SPANNERS JUMBO	28
RING SPANNER SETS	29
COMBINATION RING & OPEN SPANNERS ELLIPTICAL PATTERN	30
COMBINATION RING & OPEN SPANNERS	31
COMBINATION SPANNER SETS ELLIPTICAL PATTERN	32
COMBINATION SPANNER SETS	32
WHEEL SPANNERS - HEAVY DUTY	33
FOUR WAY WHEEL SPANNERS	34
SINGLE OPEN END SPANNERS	34
SLOGGING SPANNER OPEN END	35
SLOGGING SPANNER RING END	36
FLAT SCREW DRIVERS	37
PHILLIPS SCREW DRIVER (+)	37
REVERSIBLE SCREW DRIVER (-,+)	38
TESTER WITH NEON BULB	38
SCREW DRIVER SET	38
HEX ALLEN KEYS	39

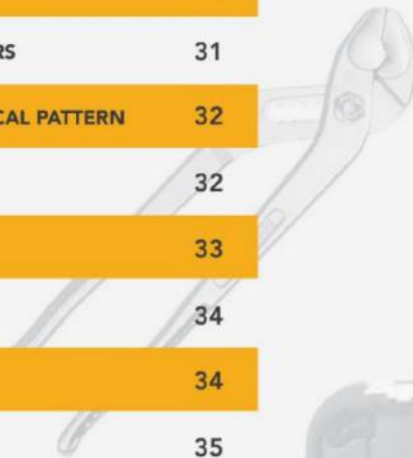

<b>HEX ALLEN KEYS SET - SHORT PATTERN</b>	<b>39</b>
<b>BALL POINT ALLEN KEY SET – LONG PATTERN</b>	<b>40</b>
<b>TORX ALLEN KEY SET</b>	<b>40</b>
<b>BALL PEIN HAMMER WITH WOODEN HANDLE</b>	<b>41</b>
<b>BALL PEIN HAMMER WITH FIBREGLASS HANDLE</b>	<b>41</b>
<b>CLUB HAMMERS WITH WOODEN HANDLE HSN - 8205</b>	<b>42</b>
<b>CLUB HAMMERS WITH FIBERGLASS HANDLE HSN - 8205</b>	<b>42</b>
<b>SLEDGE HAMMERS WITH WOODEN HANDLE</b>	<b>43</b>
<b>SLEDGE HAMMERS WITH FIBERGLASS HANDLE</b>	<b>43</b>
<b>SOFT FACED PLASTIC HAMMERS</b>	<b>44</b>
<b>BENCH VICE HEAVY DUTY</b>	<b>45</b>
<b>ENGINEERS STEEL VICE, STRAIGHT JAWS</b>	<b>45</b>
<b>HYDRAULLIC BOTTLE JACKS</b>	<b>46</b>
<b>HYDRUALLIC TROLLEY JACK</b>	<b>46</b>
<b>TOOL CABINETS</b>	<b>47</b>
<b>TOOL BOX CANTILEVER</b>	<b>48</b>
<b>TOOL BOX CANTILEVER</b>	<b>48</b>
<b>HAND TOOL KIT 15 PCS SET</b>	<b>49</b>
<b>HAND TOOL KIT 126 PCS SET</b>	<b>49</b>

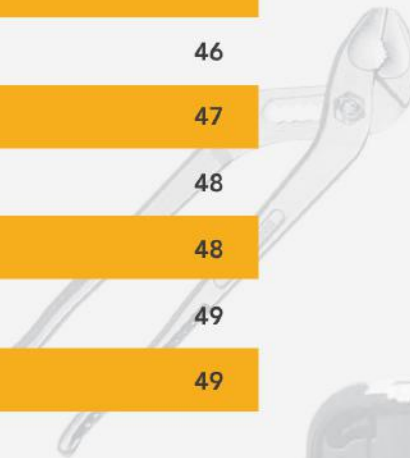

# 01 AIR OPERATED GREASE RATIO PUMP

- Best in class, easy to use high-pressure grease ratio pump dispenses grease upto **50 times** the air inlet pressure.
- Grease with high viscosity is injected by high pressure created from reciprocating pump.
- Ideal for use in automobiles, tractors, earthmoving equipment's, workshops for bulk greasing applications.
- Supplied complete with heavy duty steel drum with sturdy 5" wheels, drum cover, rubber follower plate, 4mtr (168") long R2 high pressure grease hose along with z-swivel grease gun extension & coupler.
- Pump only model's available fits directly to standard grease buckets.
- Pump is recommended for use with clean grease upto NLGI 2.



GRP-25

Technical Details	
Pressure Ratio	50:1
Recommended Working Pressure	5-8 Bar
Maximum Working Pressure	10 Bar
Grease Output	Upto 0.85 ltr/min
Transmission Pressure	300-400 Bar
Blocked Pressure	Upto 500 Bar
Delivery Hose Id	6mm
Delivery Hose Length	4mtrs/4000mm

Develops	Delivers
UPTO 7,500 PSI (517 BAR)	UPTO 0.85 LTR / MINUTE

Order Code	Size	Cartoon Packing
<b>Air Operated Grease Pump with Drum</b>		
GRP-10	10Kgs	1
GRP-15	15Kgs	1
GRP-25	25Kgs	1
GRP-50	50Kgs	1
<b>Pump Only models supplied with Drum Cover, Follower Plate, Hose, Swivel Gun</b>		
GRP-25P	Fits Directly to 20to25kg Standard grease bucket	1
GRP-50P	Fits Directly to 50kg Standard grease bucket	1

**Cautions :**



Pump must be supplied with clean & dry compressed air through FRL unit.  
Do not run the machine with loads while grease is insufficient in barrel.

## 02 GREASE BUCKET PUMP

- Aluminium Die Cast CNC Machined Robust Pump Head
- Suitable For Greasing in Commercial Vehicles in **Earth Moving Equipments, Agricultural Machines, in Automotive Applications** & in other General Purpose Bulk Greasing Applications
- For Use With NLG1, NLG2 and NLG3 Greases



**DELIVERS**  
Upto 9gms / stroke



**GBP-10**

Order Code	Description	Inner Packing	Cartoon Packing
GBP-3	3.5Kg without Wheel	1	4
GBP-6	6Kg without wheel	1	4
GBP-6W	6Kg with wheel	1	4
GBP-10	10Kg without wheel	1	4
GBP-10W	10Kg with wheel	1	4
GBP-15	15Kg without wheel	1	1
GBP-15W	15Kg with wheel	1	1
GBP-20W	20Kg with wheel	1	1
<b>SPARE PARTS</b>			
HOS-GBP-2	Rubber Hose 2mtr length x 1/4" ID	1	10
FLP-GBP-01	Follower Plate	1	10
KIT-GBP-04	O-ring Kit	1	50
KIT-GBP-16	Service Pack	1	10

## GREASE BUCKET PUMP



GBP-6



GBP-6W



GBP-10W



GBP-15W



### 03 LEVER GREASE GUN – PROFESSIONAL

- High-quality professional grease gun comes with Aluminium Die Cast Head with bulk Loader
- Durable Powder Coated Finish
- Capacity 500gms bulk/ 400gms cartridge



**DELIVERS**  
Upto 1gms / stroke



Order Code	Description	Inner Packing	Cartoon Packing
GG5-6R-Y	With 150mm rigid steel extn & 4 jaw coupler, Color Yellow	1	20
GG5-6R-B	With 150mm rigid steel extn & 4 jaw coupler, Color Black	1	20

### 04 MINI LEVER GREASE GUN

- Mini Grease Gun are used for greasing in places where standard grease guns cannot reach.
- Die Cast Strong Head
- Durable Powder Coated Finish
- Capacity 225gms bulk/ 8 Oz



**DELIVERS**  
Upto 1gms / stroke



Order Code	Description	Inner Packing	Cartoon Packing
GGM-6R	With 150mm rigid steel extn & 4 jaw coupler	1	24

### 05 LEVER GREASE GUN – STANDARD

- Best Seller standard grease gun, used in all sorts of greasing applications
- Drop Resistant Steel Head with bulk Loader
- Durable Powder Coated Finish
- Capacity 500gms bulk/ 400gms cartridge



**DELIVERS**  
Upto 1gms / stroke



Order Code	Description	Inner Packing	Cartoon Packing
GG5-6R	With 150mm rigid steel extn & 4 jaw coupler	1	20
GG5-6F	With 300mm flexible hose & 4 jaw coupler	1	20

## 06 ROTARY BARREL PUMP

- Tough, Durable Cast Iron Housing
- Heavy Duty Pump for transferring fluids like Lubricating Oils, Motor Oils, Heating Oils etc.
- Complete with 1mtr Steel suction tube for use with 210 Litre Drum



**DELIVERS**

Upto 5 Ltr/20 Turns

Order Code	Description	Inner Packing	Cartoon Packing
D-RBP-5R	1" Inlet, 3/4" Outlet	1	8

## 07 FOOT OPERATED PUMP

- High Pressure greasing pump for use in mining industry, excavators, earthmoving equipment, agricultural machines, automotive industry etc.
- Easily operated using Foot lever, reduces operator fatigue & ensures reliable high-pressure greasing.
- Pump is operated by single person for greasing makes it cost effective for everyday use



**DELIVERS**

Upto 5gms / stroke



GPF-10



GPF-12

Order Code	Capacity	Cartoon Packing
GPF-10	10kg	1
GPF-12	12kg	1

## 08 GREASE GUN HOSES

- Fully Flexible hoses for greasing fittings difficult to reach.
- Hydraulic Crimped thread end fittings 1/8" BSPT thread.
- Working Pressure 3500 PSI.



For use with  
**Hand  
Operated Grease Guns**

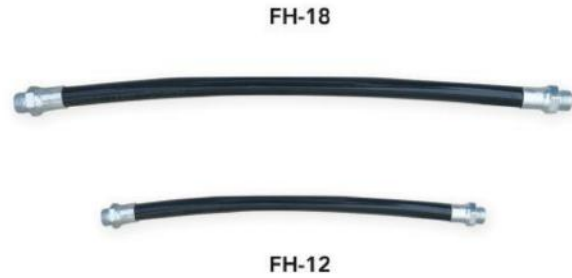

Order Code	Description	Inner Packing	Cartoon Packing
FH-12	300mm (12") Length	10	100
FH-18	450mm (18") Length	10	60

## 09 GREASE GUN STEEL EXTENSION

- Heavy Duty Steel Construction
- Fine Rolled 1/8" BSPT Male Thread on Both Ends
- Available in Straight & Bent types



**DELIVERS**  
Upto 1gms / stroke



Order Code	Description	Inner Packing	Cartoon Packing
EX-6	150mm Rigid Steel Extension Bent Type	50	200
EX-4	100mm Rigid Steel Extension Straight Type	50	200

## 10 HYDRAULIC COUPLERS

- Manufactured from Spring Steel.
- Hardened Jaws With Non Return Ball Check Valve.
- Working Pressure 6,000 PSI
- Recommended for use with Hand Operated Grease Gun

**DELIVERS**  
Upto 5 Ltr/20 Turns



HC-4

Order Code	Description	Inner Packing	Cartoon Packing
HC-3	3-Jaw	50	200
HC-4	4-Jaw	50	200

## 11 GREASE FITTINGS

- Mfd. from high quality bright steel - as per SAE-J534/ DIN 71412.
- Nipple Head (Tip) only, case hardened to 550HV minimum.
- Available in large selection of size/types in parallel & taper thread.
- Dome type riveting to hold spring



upto 8,000 PSI



30°

45°

Straight

Order Code	Description	Hex Size	Overall Length	Inner Packing
DGF/6/1	M6x1 Straight	7mm	16mm	100
DGF/6/1/45	M6x1 45° Hex	9mm	23.5mm	100
DGF/6/1/90	M6X1 90° Hex	9mm	18mm	100
DGF/8/1	M8x1 Straight	9mm	16mm	100
DGF/8/1/45	M8x1 45° Hex	9mm	23.5mm	100
DGF/8/1/90	M8X1 90° Hex	9mm	18mm	100
DGF/8/1.25	M8x1.25 Straight	9mm	16mm	100
DGF/10/1	M10x1 Straight	11mm	16mm	100
DGF/10/1/45	M10x1 45° Hex	11mm	23.5mm	100
DGF/10/1/90	M10X1 90° Hex	11mm	18mm	100
DGF/10/1.5	M10x1.5 Straight	11mm	16mm	100
DGF/10/1.5/45	M10x1.5 45° Hex	11mm	23.5mm	100
DGF/10/1.5/90	M10X1.5 90° Hex	11mm	18mm	100
DGF/1-8/1	1/8 BSP Straight	11mm	16mm	100
DGF/1-8/1/45	1/8 BSP 45° Hex	11mm	23.5mm	100
DGF/1-8/1/90	1/8 BSP 90° Hex	11mm	18mm	100
DGF/1-4/1	1/4 BSP Straight	14mm	16mm	100
DGF/1-4/1/45	1/4 BSP 45° Hex	14mm	23.5mm	100
DGF/1-4/1/90	1/4 BSP 90° Hex	14mm	18mm	100

## 12 OIL CANS

- Heavy Duty Steel Body in Powder Coated finish.
- Steel Pump with two ball valve for large Volume delivery.
- Comes with 150mm (6") rigid Steel Spout or Flexible Spout.



Order Code	Description	Cartoon Packing	Price Per Pc. (₹)
D-W275R	1/2 Pint 275cc with Rigit Spout	72	120.00/-
D-W275F	1/2 Pint 275cc with Flexible Spout	72	120.00/-

# Pliers



Induction hardened cutting edges for the ultimate performance

Hardened and tempered chrome vanadium steel for strength and durability

Heavy-duty pattern handle with soft grips for comfort

Expert Quality, drop forged from chrome vanadium steel hardened and tempered with additionally induction hardened cutting edges.

Lacquered finish for corrosion protection with heavy-duty, soft-grip handles with slip guards.

## 13 COMBINATION PLIER WITH SIDE CUTTER

- Drop Forged from High-Quality Chrome Vanadium steel
- Heat-treated body for strength & durability  
Induction hardened cutting edge(54-58HRC)  
for cutting soft to medium-hard wires
- Comfortable grip for convenience in use
- Generally confirming to IS3650-1981



Order Code	Description	Inner Packing	Cartoon Packing
D-1621-6	150mm-6"	10	100
D-1621-8	200mm-8"	10	80

## 14 SIDE CUTTING PLIER

- Side Cutting Pliers or Diagonal Pliers are mainly used by electricians for cutting wires.
- Drop Forged from High-Quality Chrome Vanadium steel
- Heat-treated body for strength & durability  
Induction hardened cutting edge (54-58HRC)  
for cutting soft to medium-hard wires
- Comfortable grip for convenience in use
- Generally confirming to IS4378-1990



Order Code	Description	Inner Packing	Cartoon Packing
D-1621-6	150mm-6	10	100

## 15 LONG NOSE PLIER

- Drop Forged from High-Quality Chrome Vanadium steel
- Heat-treated body for strength & durability  
Induction hardened cutting edge (54-58HRC)  
for cutting soft to medium-hard wires
- Comfortable grip for convenience in use
- Generally confirming to IS3552-1989



Order Code	Description	Inner Packing	Cartoon Packing
D-1420-6	150mm-6"	10	100

## 16 WATER PUMP PLIER BOX JOINT TYPE (WITH DIP INSULATION)

- Water Pump Pliers or Box Joint Pliers are commonly used for clamping pipes, turning & holding nut & bolts  
Serrated jaws are set at 45°
- Drop forged from High-Grade Carbon Steel
- Hardened & Tempered jaws for strength & durability
- Cushion grip handle for comfort in use



Order Code	Description	Inner Packing	Cartoon Packing
D-1225B	250mm-10"	10	80

## 17 WATER PUMP PLIER SLIP JOINT TYPE

- Carbon Steel
- Hardened & Tempered
- Generally Conforming to IS 6118-1991



Order Code	Description	Inner Packing	Cartoon Packing
D-1225S	250mm-10"	10	80

## 18 VICE GRIP PLIER

- Vice Grip Pliers or Locking Pliers are commonly used to hold Metal parts in place for welding. These Pliers are also used for Holding rounded nuts & bolts, holding pipes without squeezing Or used as temporary levers/knob on equipment/machinery.
- Manufactured from High Quality Chrome Vanadium Steel
- Hardened & Tempered for strength & durability
- Serrated Gripping surface and adjustable opening, with Quick-release lever



Order Code	Description	Inner Packing	Cartoon Packing
D-1641-7	175mm-7"	5	50
D-1641-10	250MM-10"	5	50



## 19 ADJUSTABLE WRENCHES

- Drop Forged from high grade steel, hardened & Tempered for strength & durability
- Left hand screw movement as standard.
- Black phosphated for corrosion protection.
- Generally conforming to IS6149-1984 Grade III



Order Code	Size mm / inch	Opening Capacity (MM)	Cartoon Packing
D-1170-6	155 / 6"	19	100
D-1171-8	205 / 8"	26	80
D-1172-10	255 / 10"	30	50
D-1173-12	305 / 12"	35	30
D-1174-15	380 / 15"	43	20

## 20 PIPE WRENCH STILSON PATTERN

- Jaws are drop forged from high-quality carbon steel
- Precision machined integral teeth with an included angle Of 76° of the teeth of Jaws provide accurate matching, Which ensures firm gripping of the job without leaving biting marks In comparison to other pipe wrenches.
- Differential hardness pattern of the handle and jaw permits wear resistance teeth and durable body
- Generally conforming to IS4003 (I) 1978



Order Code	Size mm / inch	Opening Capacity (MM)	Cartoon Packing
D-1271HD	8" / 200	33	40
D-1272	10" / 250	33	40
D-1273	12" / 300	42	30
D-1274	14" / 350	48	25
D-1275	18" / 450	60	16
D-1276	24" / 600	73	8
D-1277	36" / 900	94	4
D-1278HD	48" / 1200	110	4

## 21 FILTER WRENCH BELT TYPE

- Drop forged steel handle with powder coated finish
- Non-marring nylon belt
- For objects with Dia upto4"(100mm)



Order Code	Size	Cartoon Packing
D-FTL-9	225mm	96

## 22 FILTER WRENCH BELT TYPE

- Aluminum I beam handle
- Non-marring nylon belt
- For objects with Dia upto9"(230mm)



Order Code	Size	Cartoon Packing
D-FTL-12	300mm	60

# Sockets & Accessories

Long Work Life

Hex/Bi-Hex  
Designing



Electroplate( 0.9-1.2um )  
Salt Spray Test ( 48 Hours)



CR-V Material



30% Higher  
DIN Standard



## 23 12.5MM (1/2") DRIVE ALLEN SOCKETS

- Chrome Vanadium Steel
- Chrome Plated
- Mirror Finish
- Generally Conforming to IS 7381-1986



Size (mm)	Inner Packing	Cartoon Packing
H4	10	200
H5	10	200
H6	10	200
H8	10	200
H10	10	200
H12	10	200
H14	10	200
H17	10	200
H19	10	200

## 24 12.5MM (1/2") DRIVE TORX BIT SOCKETS

- Chrome Vanadium Steel
- Chrome Plated
- Mirror Finish
- Generally Conforming to IS 7381-1986



Size (mm)	Inner Packing	Cartoon Packing
T10	10	200
T20	10	200
T25	10	200
T27	10	200
T30	10	200
T35	10	200
T40	10	200
T45	10	200
T50	10	200
T55	10	200
T60	10	200

## 25 12.5MM (1/2") DRIVE E-SOCKETS

- Chrome Vanadium Steel
- Chrome Plated
- Mirror Finish
- Generally Conforming to IS 7381-1986



Size (mm)	Inner Packing	Cartoon Packing
E10	10	200
E11	10	200
E12	10	200
E14	10	200
E16	10	200
E18	10	200
E20	10	200
E22	10	200
E24	10	200

## 26 12.5MM (1/2") DRIVE HEX & BI-HEX SOCKET SET

- Chrome Vanadium Steel
- Double Chrome Plated
- Mirror Finish
- BMC Box Packing
- Generally Conforming to IS 7991-1991



Order Code	Set Name	Contents in Blow Case	Cartoon Packing
D-S24H	24 Pcs Socket Set Hex/Bi-Hex (19 Sockets & 5 Accessories)	Socket 8-22, 24, 27, 30, 32mm Extension Bar 125, 250mm Sliding T-Handle Universal Joint Reversible Ratchet Handle with Quick Release	4 Sets

## 27 6.35MM (1/4") DRIVE HEX SOCKET SET

- A collection of most commonly used sockets & accessories
- Neatly packed in heavy duty BMC box for safe & convenient Storage.



Order Code	Set Name	Contents in Blow Case	Cartoon Packing
D-S46H	1/4 " sq dr 46 Pcs Socket Set Hex	Sockets 13 Pcs - 4, 4.5, 5, 5.5, 6, 7, 8, 9, 10, 11, 12, 13, 14mm Bit Socket (Hex) - 3,4,5,6,7,8mm Bit Socket (Star) - T10, T15, T20, T25, T30, T40mm, Bits Sockets (Slotted) - 4, 5.5, 7mm Bits Socket (phillips) - PH1, PH2, PH3, Bits Socket (pozidrive) - PZ1, PZ2, PZ3, Key Wrench - 1.27, 1.5, 2, 2.5mm, Extn Bar 50 & 100mm, Sliding Tbar 115mm, U joint, Ratchet 72T with grip Flexible Extension, Bit Adopter, Spinner handle	10 Sets

## 28 19MM (3/4") DRIVE HEX & BI-HEX SOCKET SET

- A collection of most commonly used sockets & accessories
- Neatly packed in heavy duty BMC box for safe & convenient Storage.



Order Code	Set Name	Contents in Blow Case	Cartoon Packing
D-S16H	16 Pcs Socket Set Hex/Bi-Hex (12 Sockets & 4 Accessories)	Socket 19,21,22, 24, 27,30, 32,36,38,41,46,50mm Extension Bar 200, 400mm Adaptor 3/4 to 1/2 Reversible Ratchet Handle	2 Sets

## 29 19MM (3/4") DRIVE HEX & BI-HEX SOCKETS

- Chrome Vanadium Steel
- Chrome Plated
- Mirror Finish
- Generally Conforming to IS 7381-1986



Size		Cartoon Packing
Metric mm	6Pt / 12Pt	
19	Hex / Bi-Hex	10
22	Hex / Bi-Hex	10
24	Hex / Bi-Hex	10
27	Hex / Bi-Hex	10
28	Hex / Bi-Hex	10
1-1/8 SAE	Hex / Bi-Hex	10
29	Hex / Bi-Hex	10
30	Hex / Bi-Hex	10
32	Hex / Bi-Hex	8
33	Hex / Bi-Hex	8
34	Hex / Bi-Hex	8
35	Hex / Bi-Hex	6
36	Hex / Bi-Hex	6
38	Hex / Bi-Hex	6
40	Hex / Bi-Hex	5
41	Hex / Bi-Hex	5
42	Hex / Bi-Hex	5
46	Hex / Bi-Hex	3
48	Hex / Bi-Hex	3
50	Hex / Bi-Hex	3
52	Hex / Bi-Hex	3
55	Hex / Bi-Hex	3
60	Hex / Bi-Hex	2
65	Hex / Bi-Hex	2

## 30 12.5MM (1/2") DRIVE HEX & BI-HEX SOCKETS

- DURELO sockets are Cold forged from high quality chrome vanadium steel, Hardened & tempered to HRC39-45 for extra strength & longer life.
- Round drive design results in stronger retention force due to firm grip between socket & nuts & bolts. Hence DURELO sockets can achieve upto 30% higher torque as per DIN standard.
- Superior mirror finish by Chrome plating (1-1.2 um) passes through Salt Spray Test 48Hours  
Anti-slip band on socket provides ease of use even in Slippery applications.



Size		Cartoon Packing
Metric mm	6Pt / 12Pt	
8	Hex / Bi-Hex	100
9	Hex / Bi-Hex	100
10	Hex / Bi-Hex	100
11	Hex / Bi-Hex	100
12	Hex / Bi-Hex	100
13	Hex / Bi-Hex	100
14	Hex / Bi-Hex	100
15	Hex / Bi-Hex	100
16	Hex / Bi-Hex	100
17	Hex / Bi-Hex	100
18	Hex / Bi-Hex	120
19	Hex / Bi-Hex	120
20	Hex / Bi-Hex	120
21	Hex / Bi-Hex	120
22	Hex / Bi-Hex	120
23	Hex / Bi-Hex	120
24	Hex / Bi-Hex	120
25	Hex / Bi-Hex	60
26	Hex / Bi-Hex	60
27	Hex / Bi-Hex	60
28	Hex / Bi-Hex	60
29	Hex / Bi-Hex	60
30	Hex / Bi-Hex	60
32	Hex / Bi-Hex	60
33	Hex / Bi-Hex	60
34	Hex / Bi-Hex	60



## 31 12.5MM (1/2")DRIVE HEX & BI-HEX LONG SOCKETS

- Chrome Vanadium Steel
- Chrome Plated
- Mirror Finish
- Generally Conforming to IS 7381-1986



Size		Cartoon Packing
Metric mm	6Pt / 12Pt	
8	Hex / Bi-Hex	144
10,11	Hex / Bi-Hex	144
12	Hex / Bi-Hex	144
13	Hex / Bi-Hex	144
14,15	Hex / Bi-Hex	144
17,18	Hex / Bi-Hex	144
19	Hex / Bi-Hex	144
21,22	Hex / Bi-Hex	144
24	Hex / Bi-Hex	144
26	Hex / Bi-Hex	144
27	Hex / Bi-Hex	144
28	Hex / Bi-Hex	144
29	Hex / Bi-Hex	144
30	Hex / Bi-Hex	144
32	Hex / Bi-Hex	144

## 32 12.5MM (1/2") DRIVE SPARK PLUG SOCKETS

- Chrome Vanadium Steel
- Chrome Plated
- Mirror Finish
- Generally Conforming to IS 7381-1986



Order Code	size (MM)	Cartoon Packing
SP-16	16	144
SP-21	21	144

### 33 EXTENSION BAR

- Chrome Vanadium Steel
- Chrome Plated Mirror Finish
- Generally Conforming to IS 7991-1991



D-2763

Order Code	Drive	Length (MM)	Inner Packing	Cartoon Packing
D-1743	1/2"	75	10	200
D-1753	1/2"	125	10	120
D-1763	1/2"	250	10	60
D-2743	3/4"	125	6	60
D-2753	3/4"	200	6	48
D-2763	3/4"	400	2	24

### 34 L-HANDLE

- Chrome Vanadium Steel
- Chrome Plated Mirror Finish



Order Code	Drive	Length (MM)	Inner Packing	Cartoon Packing
D-1734	1/2"	200	6	
D-1735	1/2"	250	6	60
D-1736	1/2"	300	6	48
D-1737	1/2"	450	6	24
D-1738	3/4"	450	2	20

## 35 REVERSIBLE RATCHET HANDLE

- Chrome Vanadium Steel
- Generally Conforming to IS 7975-1991



Order Code	Drive	Inner Packing	Cartoon Packing
D-1715	1/2"	6	36
D-2715	3/4"	1	10

## 36 SLIDING T-HANDLE

- Chrome Vanadium Steel
- Generally Conforming to IS 7975-1991



Order Code	Drive	Length (MM)	Inner Packing	Cartoon Packing
D-1733	1/2"	300	6	60
D-2733	3/4"	500	2	20

## 37 UNIVERSAL JOINT

- Chrome Vanadium Steel
- Chrome Plated Mirror Finish
- Generally Conforming to IS 7991-1991



Order Code	Drive	Inner Packing	Cartoon Packing
D-1773	1/2"	6	120

## 38 SOCKET ADAPTORS

- Chrome Vanadium Steel
- Chrome Plated Mirror Finish



Order Code	Drive		Inner Packing	Cartoon Packing
	Male	Female		
D-A38M12F	3/8	1/2	10	120
D-A12M38F	1/2	3/8	10	120
D-A34M12F	3/4	1/2	6	120
D-A12M34F	1/2	3/4	6	120

## 39 SWIVEL HANDLE

- Chrome Vanadium Steel
- Generally Conforming to IS 7975-1991



Order Code	Drive	Length (MM)	Inner Packing	Cartoon Packing
D-SWH-4	1/2"	380	6	24

## 40 SPEED BRACE

- Chrome Vanadium Steel
- Generally Conforming to IS 7975-1991

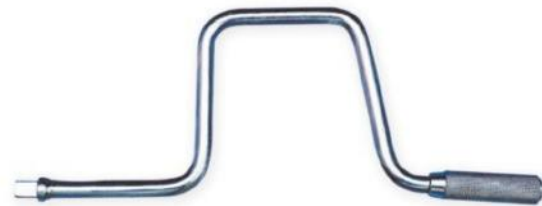

Order Code	Drive	Length (MM)	Inner Packing	Cartoon Packing
D-SBH-15	1/2"	380	6	24

## 41 DOUBLE OPEN END SPANNERS

- Manufactured from High Quality Chrome Vanadium Steel, Duly Hardened & Tempered to 39-46HRC for strength & durability
- Each Head set at 15 degree Angle
- Chrome Plated for Corrosion Protection, matt finish
- Generally conforming to IS2028-2024
- Available in large selection of mm, whitworth & SAE sizes.



Size			Cartoon Packing
Metric (MM)	English (WV)	SAE	
6X7	-	-	800
8X9	-	-	800
10X11	1/8x3/16	-	600
10X12	-	-	600
10X13	-	-	400
12X13	3/16x1/4	7/16X1/2	400
14X15	1/4x5/16	-	300
14X17	-	1/2X9/16	200
16X17	5/16x3/8	-	200
17X19	5/16x7/16	-	150
18X19	3/8x7/16	-	150
19X22	-	3/4X5/8	100
20X22	-	-	100
21X23	-	-	100
22X24	7/16x9/16	-	100
24X26	1/2x9/16	-	80
24X27	-	-	80
25X28	9/16x5/8	-	60
27X30	-	-	60
27X32	11/16x9/16	-	60
30X32	5/8x3/4	-	60

## 42 DOUBLE OPEN END JUMBO SPANNERS

- Manufactured from High Quality Chrome Vanadium Steel, Duly Hardened & Tempered to 39-46HRC for strength & durability
- Each Head set at 15 degree Angle
- Chrome Plated for Corrosion Protection, matt finish
- Generally conforming to DIN-895
- Available in large selection of mm, whitworth & SAE sizes.



Metric (MM)	Size		Cartoon Packing
	English (ww)	SAE	
32X36	3/4x7/8	-	30
34X36	-	-	30
34X38	-	-	30
36X41	1x1-1/8	-	30
41X46	1-1/8x1-1/4	-	20
46X50	-	-	20
50X55	-	-	10
55X60	-	-	10
60X65	-	-	5
65X70	-	-	5
70X75	-	-	5
75X80	-	-	5

## 43 DOUBLE OPEN END SPANNER SETS

- Manufactured from High Quality Chrome Vanadium Steel, Duly Hardened & Tempered to 39-46HRC for strength & durability Each Head set at 15 degree Angle
- Chrome Plated for Corrosion Protection, matt finish
- Generally conforming to IS2028-2024
- Available in attractive Box Packing or Tool Bag Packing



### Double Open End Spanner Sets – Box Packing

Set No.	Pcs. Per Set	Sets Size	Cartoon Packing
D-1206M	6	6x7,8x9,10x11,12x13,14x15,16x17	40
D-1208M	8	6x7,8x9,10x11,12x13,14x15,16x17 18x19, 20x22	40
D-1210M	10	6x7,8x9,10x11,12x13,14x15,16x17 18x19, 20x22,21x23,24x27	20
D-1210S	10	6x7,8x9,10x11,12x13,14x15,16x17 18x19, 20x22,24x27,30x32	20
D-1212M	12	6x7,8x9,10x11,12x13,14x15,16x17 18x19,20x22,21x23,24x27,25x28 30x32	16
D-1206W	6	1/8x3/16, 3/16x14, 1/4x5/16, 5/16x3/8,3/8x7/16,7/16x1/2ww	40
D-1209W	9	1/8x3/16, 3/16x14, 1/4x5/16, 5/16x3/8,3/8x7/16,7/16x1/2, 1/2x9/16,9/16x5/8,5/8x3/4ww	16

### Double Open End Spanner Sets – Tool Bag Packing

D-1208M/TB	8	6x7,8x9,10x11,12x13,14x15,16x17 18x19, 20x22	40
D-1212M/TB	12	6x7,8x9,10x11,12x13,14x15,16x17 18x19,20x22,21x23,24x27,25x28 30x32	16

## 44 BI HEXAGONAL RING SPANNERS - SHALLOW OFFSET

- Manufactured from High Quality Chrome Vanadium Steel, Duly Hardened & Tempered to 39-46HRC for strength & durability
- Chrome Plated for Corrosion Protection, matt finish
- Generally conforming to IS2029-2024 .
- Available in large selection of mm, whitworth & SAE sizes



Metric (MM)	Size		Cartoon Packing
	English (ww)	SAE	
6X7	-	-	300
8X9	-	-	300
10X11	1/8x3/16	-	300
12X13	3/16x1/4	-	200
14X15	1/4x5/16	-	150
14X17	-	-	150
16X17	5/16x3/8	-	150
16X18	5/16x7/16	-	150
17X19	-	-	100
18X19	3/8x7/16	-	100
19X22	-	5/8x11/16	100
-	7/16x1/2	-	100
20X22	-	-	100
21X23	7/16x9/16	-	50
24X26	1/2x9/16	-	50
24X27	9/16x5/8	-	50
25X28	11/16x9/16	-	40
27X32	5/8x3/4	-	40
30X32	9/16x11/16	-	40



## 45 RING SPANNERS JUMBO

- Manufactured from High Quality Chrome Vanadium Steel, Duly Hardened & Tempered to 39-46HRC for strength & durability
- Chrome Plated for Corrosion Protection, matt finish
- Generally conforming to DIN-838.
- Available in large selection of mm, whitworth & SAE sizes.



Metric (MM)	Size		Cartoon Packing
	English (ww)	SAE	
32X36	3/4x7/8	-	20
34X36	-	-	10
34X38	-	-	10
36X41	-	-	10
41X46	1x1-1/8	-	10
-	1-1/8x1-1/4	-	10
46X50	-	-	10
50X55	-	-	5
55X60	-	-	5
60X65	-	-	5
65X70	-	-	5
70X75	-	-	5
75X80	-	-	5

## 46 RING SPANNER SETS

- Manufactured from High Quality Chrome Vanadium Steel, Duly Hardened & Tempered to 39-46HRC for strength & durability
- Chrome Plated for Corrosion Protection, matt finish
- Generally conforming to IS2029-2024
- Available in large selection of mm, whitworth & SAE sizes



### Ring Spanner Sets – Box Packing

Set No.	Pcs. Per Set	Sets Size	Cartoon Packing
D-1806M	6	6x7,8x9,10x11,12x13,14x15,16x17	30
D-1808M	8	6x7,8x9,10x11,12x13,14x15,16x17 18x19, 20x22	20
D-1810M	10	6x7,8x9,10x11,12x13,14x15,16x17 18x19, 20x22,21x23,24x27	10
D-1810S	10	6x7,8x9,10x11,12x13,14x15,16x17 18x19, 20x22,24x27,30x32	10
D-1812M	12	6x7,8x9,10x11,12x13,14x15,16x17 18x19,20x22,21x23,24x27,25x28 30x32	8
D-1806W	6	1/8x3/16, 3/16x14, 1/4x5/16, 5/16x3/8,3/8x7/16,7/16x1/2ww	20
D-1809W	9	1/8x3/16, 3/16x14, 1/4x5/16, 5/16x3/8 3/8x7/16,7/16x1/2, 1/2x9/16, 9/16x5/8,5/8x3/4ww	10

### Ring Spanner Sets – Tool Bag Packing

D-1808M/TB	8	6x7,8x9,10x11,12x13,14x15,16x17 18x19, 20x22	40
D-1812M/TB	12	6x7,8x9,10x11,12x13,14x15,16x17 18x19,20x22,21x23,24x27,25x28 30x32	16

## 47 COMBINATION RING & OPEN SPANNERS ELLIPTICAL PATTERN

- Manufactured from High Quality Chrome Vanadium Steel, Duly Hardened & Tempered to 39-46HRC for strength & durability
- Chrome Plated for Corrosion Protection, matt finish
- Generally conforming to IS6389-1972
- Available in large selection of mm sizes.



Product no.	Size Metric (mm)	Inner Packing	Cartoon Packing
D14-06E	6	10	500
D14-07E	7	10	500
D14-08E	8	10	400
D14-09E	9	10	400
D14-10E	10	10	400
D14-11E	11	10	300
D14-12E	12	10	300
D14-13E	13	10	300
D14-14E	14	10	200
D14-15E	15	5	150
D14-16E	16	5	150
D14-17E	17	5	125
D14-18E	18	5	100
D14-19E	19	5	100
D14-20E	20	5	100
D14-21E	21	5	75
D14-22E	22	5	75
D14-23E	23	5	50
D14-24E	24	5	50
D14-27E	27	5	30
D14-30E	30	5	30
D14-30E	32	5	30

## 48 COMBINATION RING & OPEN SPANNERS

- Manufactured from High Quality Chrome Vanadium Steel, Duly Hardened & Tempered to 39-46HRC for strength & durability
- Chrome Plated for Corrosion Protection, matt finish Generally conforming to IS6389-1972
- Available in large selection of mm sizes.



Product no.	Size Metric (MM)	Inner Packing	Cartoon Packing
D14-06	6	10	600
D14-07	7	10	600
D14-08	8	10	600
D14-09	9	10	600
D14-10	10	10	500
D14-11	11	10	400
D14-12	12	10	400
D14-13	13	10	300
D14-14	14	10	250
D14-15	15	5	150
D14-16	16	5	150
D14-17	17	5	125
D14-18	18	5	100
D14-19	19	5	100
D14-20	20	5	100
D14-21	21	5	75
D14-22	22	5	75
D14-23	23	5	50
D14-24	24	5	50
D14-25	25	5	50
D14-26	26	5	40
D14-27	27	5	40
D14-28	28	5	40
D14-29	29	5	30
D14-30	30	5	30
D14-32	32	5	30

## 49 COMBINATION SPANNER SETS ELLIPTICAL PATTERN

- Manufactured from High Quality Chrome Vanadium Steel, Duly Hardened & Tempered to 39-46HRC for strength & durability
- Chrome Plated for Corrosion Protection, matt finish
- Generally conforming to IS6389-1972
- Available in attractive box packing or tool bag packing.

BOX PACKING			
Set No.	Pcs. Per Set	Sets Size	Cartoon Packing
D-1412E	12	6,7,8,9,10,11,12,13,14,17,19,22	30
D-1424E	24	6,7,8,9,10,11,12,13,14,15,16,17,18,19,20,21,22,24,25,26,27,28,30,32	16
TOOL BAG PACKING			
D-1412E/TB	12	6,7,8,9,10,11,12,13,14,17,19,22	30
D-1424E/TB	24	6,7,8,9,10,11,12,13,14,15,16,17,18,19,20,21,22,24,25,26,27,28,30,32	16

## 50 COMBINATION SPANNER SETS

- Manufactured from High Quality Chrome Vanadium Steel, Duly Hardened & Tempered to 39-46HRC for strength & durability
- Chrome Plated for Corrosion Protection, matt finish  
Generally conforming to IS6389-1972
- Available in attractive box packing or tool bag packing.



Box Packing			
Set No.	Pcs. Per Set	Sets Size	Cartoon Packing
D-1412M	12	6,7,8,9,10,11,12,13,14,17,19,22	30
D-1426M	26	6,7,8,9,10,11,12,13,14,15,16,17,18,19,20,21,22,23,24,25,26,27,28,29,30,32	4
Tool Bag Packing			
D-1412M/TB	12	6,7,8,9,10,11,12,13,14,17,19,22	30
D-1426M/TB	26	6,7,8,9,10,11,12,13,14,15,16,17,18,19,20,21,22,23,24,25,26,27,28,29,30,32	4

## 51 WHEEL SPANNERS - HEAVY DUTY

- Manufactured from High Quality Carbon Steel, Duly Hardened & Tempered to Min 35HRC
- Black Phosphated for corrosion protection
- Generally conforming to IS12521-1989



### Wheel Spanner Long Pattern – Length 400mm

Product No.	Size	Inner Box	Cartoon Packing
D27-2427	24X27	1	10
D27-2727	27X27	1	10
D27-2730	27X30	1	10
D27-2732	27X32	1	10
D27-2733	27X33	1	10
D27-3030	30X30	1	10
D27-3032	30X32	1	10
D27-3033	30X33	1	10
D27-3232	32X32	1	10
D27-3333	33X33	1	10
D27-3236	32X36	1	10
D27-2138	21X38	1	10
D27-3841	38X41	1	10
D27-2141	21X41	1	10
TB-18	TOMMY BAR 450MM	5	20
TB-44	TOMMY BAR 1100MM	5	10

### Wheel Spanner Short Pattern – Length 260mm

D27-2427S	24X27	1	10
D27-2727S	27X27	1	10
D27-2730S	27X30	1	10
D27-2732S	27X32	1	10
D27-2733S	27X33	1	10
D27-3030S	30X30	1	10
D27-3032S	30X32	1	10
D27-3033S	30X33	1	10
D27-3232S	32X32	1	10
D27-3333S	33X33	1	10
D27-3236S	32X36	1	10
D27-2138S	21X38	1	10
D27-3841S	38X41	1	10
D27-2141S	21X41	1	10

## 52 FOUR WAY WHEEL SPANNERS

- Manufactured from High Carbon Steel, Duly Hardened & Tempered to Min 35HRC
- Chrome Plated for Corrosion Protection, matt finish
- Generally Conforming to IS 12521-1989



Order Code	Description	Cartoon Packing
DFW-7981	17, 18, 19, 21	20
DFW-7193	17, 19, 21, 23	20

## 53 SINGLE OPEN END SPANNERS

- Manufactured from High Quality Carbon Steel, Duly Hardened & Tempered to Min 35HRC
- Black Phosphated for corrosion protection
- Generally conforming to DIN-895



Product No.	Size (mm)
D-SOE-27	27
D-SOE-30	30
D-SOE-32	32
D-SOE-34	34
D-SOE-36	36
D-SOE-38	38
D-SOE-41	41
D-SOE-46	46
D-SOE-50	50
D-SOE-55	55
D-SOE-60	60
D-SOE-65	65
D-SOE-70	70
D-SOE-75	75
D-SOE-80	80

Product No.	Size (mm)
D-SOE-85	85
D-SOE-90	90
D-SOE-95	95
D-SOE-100	100
D-SOE-105	105
D-SOE-110	110
D-SOE-115	115
D-SOE-120	120
D-SOE-125	125
D-SOE-130	130
D-SOE-135	135
D-SOE-140	140
D-SOE-145	145
D-SOE-150	150
-	-

## 54 SLOGGING SPANNER OPEN END

- Manufactured from High Quality Chrome Vanadium Steel, Duly Hardened & Tempered to 39-46HRC for strength & durability
- Used for tightening & slackening larger nuts bolts in Earthmoving machines, mining, piping, ship repair & Other industrial applications
- Black Phosphate for corrosion protection
- Generally conforming to DIN-133



Product No.	Size (mm)
D-SSO-24	24
D-SSO-27	27
D-SSO-30	30
D-SSO-32	32
D-SSO-34	34
D-SSO-36	36
D-SSO-38	38
D-SSO-41	41
D-SSO-46	46
D-SSO-50	50
D-SSO-55	55
D-SSO-60	60
D-SSO-65	65
D-SSO-70	70
D-SSO-75	75

Product No.	Size (mm)
D-SSO-80	80
D-SSO-85	85
D-SSO-90	90
D-SSO-95	95
D-SSO-100	100
D-SSO-105	105
D-SSO-110	110
D-SSO-115	115
D-SSO-120	120
D-SSO-125	125
D-SSO-130	130
D-SSO-135	135
D-SSO-140	140
D-SSO-145	145
D-SSO-150	150



## 55 SLOGGING SPANNER RING END

- Manufactured from High Quality Chrome Vanadium Steel, Duly Hardened & Tempered to 39-46HRC for strength & durability
- Used for tightening & slackening larger nuts bolts in Earthmoving machines, mining, piping, ship repair & Other industrial applications
- Black Phosphate for corrosion protection
- Generally conforming to DIN-133



Product No.	Size (mm)
D-SSR-24	24
D-SSR-27	27
D-SSR-30	30
D-SSR-32	32
D-SSR-34	34
D-SSR-36	36
D-SSR-38	38
D-SSR-41	41
D-SSR-46	46
D-SSR-50	50
D-SSR-55	55
D-SSR-60	60
D-SSR-65	65
D-SSR-70	70
D-SSR-75	75

Product No.	Size (mm)
D-SSR-80	80
D-SSR-85	85
D-SSR-90	90
D-SSR-95	95
D-SSR-100	100
D-SSR-105	105
D-SSR-110	110
D-SSR-115	115
D-SSR-120	120
D-SSR-125	125
D-SSR-130	130
D-SSR-135	135
D-SSR-140	140
D-SSR-145	145
D-SSR-150	150

## 56 FLAT SCREW DRIVERS

- Made out of High Quality Spring Steel and Transparent PVC handle. Hardened and tempered to resist wear, bending and meet high torque requirement. Tip Harness 55-58HRC for longer life.
- Magnetised tip to lift & hold small screws in areas which are difficult to access.
- It is available in wide variety of different tip size & length.
- It is Generally Conforming to IS 844-1979



Order Code	Blade Size DiaxLength (MM)	Cartoon Packing
D-922	6x100	200
D-824	6x150	200
D-825	6x200	200
D-826	6x250	200
D-925	8x150	200
D-827	8x200	100
D-828	8x250	100
D-829	8x300	100
D-928	10x250	60
D-929	10x300	60
D-930	10x400	60
D-931	10x450	60

## 57 PHILLIPS SCREW DRIVER (+)

- Made out of High Quality Spring Steel and Transparent PVC handle. Hardened and tempered to resist wear, bending and meet high torque requirement. Tip Harness 55-58HRC for longer life.
- Magnetised tip to lift & hold small screws in areas which are difficult to access.
- It is available in wide variety of different tip size & length.
- It is Generally Conforming to IS 844-1979



Order Code	Blade Size DiaxLength (MM)	Cartoon Packing
D-861 75	5x75	200
D-862 100	6x100	200
D-862 150	6x150	200
D-862 200	6x200	200
D-863 250	8x250	100

## 58 REVERSIBLE SCREW DRIVER (-,+)

- Generally Conforming to IS 844 – 1979



Order Code	Blade Size Dia x Length (MM)	Cartoon Packing
D-904	6x100	200
D-905	6x150	200
D-907	6x200	200
D-9031	6x250	200
D-906	8x150	200
D-852	8x200	100
D-910	8x250	100

## 59 TESTER WITH NEON BULB

- Generally Conforming to IS 5579-1985 (Grade II)



Order Code	Color	Length (MM)	Inner Packing	Cartoon Packing
D-813	Yellow	125	20	100
D-814	Green	125	20	100

## 60 SCREW DRIVER SET

- Made out of High-Quality Spring Steel and Transparent PVC handle. Hardened and tempered to resist wear, bending, and meet high torque requirement. Tip Harness 55-58HRC for longer life. Magnetized tip to lift & hold small screws in areas which are difficult to access.

- It is Generally Conforming to IS 844-1979



Order Code	Description	Cartoon Packing
D-812	With Neon Bulb with Five Blades	100
D-900	With Neon Bulb with Eight Blades in 6mm Dia consisting Extn. Rod.	60

## 61 HEX ALLEN KEYS

- Made from High grade Chrome Vanadium steel. Accurately hardened & tempered to 48-52HRC to withstand higher Torque & longer durability.
- Available in black finish for corrosion protection
- Offered in large selection of mm & inches Sizes.
- Generally Conforming to IS3082-1981



Product No.	Size (MM)	Cartoon Packing
DAK-1.5	1.5	2000
DAK-2	2	2000
DAK-2.5	2.5	2000
DAK-3	3	2000
DAK-4	4	1000
DAK-5	5	1000
DAK-6	6	600
DAK-8	8	300
DAK-10	10	200
DAK-12	12	120
DAK-14	14	80
DAK-17	17	40
DAK-19	19	40
DAK-22	22	20
DAK-24	24	20

Product No.	Size (INCH)	Cartoon Packing
DAK-1/16	1/16	2000
DAK-5/64	5/64	2000
DAK-3/32	3/32	2000
DAK-1/8	1/8	2000
DAK-5/32	5/32	1000
DAK-3/16	3/16	1000
DAK-7/32	7/32	600
DAK-1/4	1/4	300
DAK-5/16	5/16	200
DAK-3/8	3/8	120
DAK-1/2	1/2	80
DAK-9/16	9/16	40
DAK-5/8	5/8	40
DAK-3/4	3/4	20
DAK-7/8	7/8	20

## 62 HEX ALLEN KEYS SET - SHORT PATTERN

- Made from High grade Chrome Vanadium steel. Accurately hardened & tempered to 48-52HRC to withstand higher Torque & longer durability.
- Available in black finish for corrosion protection
- Generally Conforming to IS3082-1988
- Neatly packed in plastic box packing.



Order Code	Content	Inner Packing	Cartoon Packing
D-AK9M	1.5,2,2.5,4,5,6,8,10mm	5	40
D-AK10I	1/16,5/64,3/32,1/8,5/32 3/16,1/4,5/16,3/8 SAE	5	40

## 63 BALL POINT ALLEN KEY SET – LONG PATTERN

- Made from High grade Chrome Vanadium steel. Accurately hardened & tempered to 48-52HRC to withstand higher Torque & longer durability.
- Available in black finish for corrosion protection
- Generally Conforming to IS3082-1988
- Neatly packed in plastic hanger packing.



Order Code	Content	Inner Packing	Cartoon Packing
LAK-9M	1.5,2,2.5,4,5,6,8,10mm	5	40
LAK-9I	1/16,5/64,3/32,1/8,5/32 3/16,1/4,5/16,3/8 SAE	5	40

## 64 TORX ALLEN KEY SET

- Made from High grade Chrome Vanadium steel. Accurately hardened & tempered to 48-52HRC to withstand higher Torque & longer durability.
- Available in black finish for corrosion protection
- Generally Conforming to IS3082-1988
- Neatly packed in plastic hanger packing.



Order Code	Content	Inner Packing	Cartoon Packing
STK-9S	T10,T15,T20,T25,T27,T30,T40,T45,T50	5	40

## 65 BALL PEIN HAMMER WITH WOODEN HANDLE

- Drop forged from high grade carbon steel.
- Partially Hardened up to 55 – 58 HRC on Striking surfaces essential functional requirements for all types of hammers.
- Painted to provide anti rusting properties
- Handle made from high quality strong wood and fixed firmly to hammer head, which does not come out even after long rough use.
- Generally Conforming to IS 841-1983



Product No.	Size (mm)	Inner Packing	Cartoon Packing
DBH-100/W	100	10	100
DBH-200/W	200	6	48
DBH-300/W	300	6	48
DBH-500/W	500	6	48
DBH-600/W	600	4	32
DBH-800/W	800	4	24

## 66 BALL PEIN HAMMER WITH FIBREGLASS HANDLE

- Drop forged from high grade carbon steel.
- Partially Hardened up to 55 – 58 HRC on Striking surfaces essential functional requirements for all types of hammers.
- Painted to provide anti rusting properties
- Fitted with high quality fiberglass handle and fixed firmly to hammer head, which does not come out even after long rough use.
- Generally Conforming to IS 841-1983



Product No.	Size (mm)	Inner Packing	Cartoon Packing
DCH-100	100	10	100
DCH-200	200	6	48
DCH-300	300	6	48
DCH-500	500	6	48
DCH-600	600	4	32
DCH-800	800	4	24

## 67 CLUB HAMMERS WITH WOODEN HANDLE HSN - 8205

- Drop forged from high grade carbon steel.
- Partially Hardened up to 55 – 58 HRC on Striking surfaces essential functional requirements for all types of hammers.
- Painted to provide anti rusting properties
- Handle made from high quality strong wood and fixed firmly to hammer head, which does not come out even after long rough use.
- Generally Conforming to IS 841-1983



Product No.	Size (GMS)	Handle Length (INCH)	Cartoon Packing
DCH-800W	800	10.5	30
DCH-1000W	1000	10.5	24
DCH-1250W	1250	10.5	24
DCH-1500W	1500	11	20
DCH-2000W	2000	13	16

## 68 CLUB HAMMERS WITH FIBERGLASS HANDLE HSN - 8205

- Drop forged from high-grade carbon steel.
- Partially Hardened up to 55 – 58 HRC on Striking surfaces essential functional requirements for all types of hammers.
- Painted to provide anti-rusting properties
- Available in Fibreglass Handle.  
Handle fixed firmly to hammer head ensures Durability



Product No.	Size (GMS)	Handle Length (INCH)	Cartoon Packing
DCH-800W	800	10.5	30
DCH-1000W	1000	10.5	24
DCH-1250W	1250	10.5	24
DCH-1500W	1500	11	20
DCH-2000W	2000	13	16

## 69 SLEDGE HAMMERS WITH WOODEN HANDLE

- Drop forged from high grade carbon steel.
- Partially Hardened up to 55 – 58 HRC on Striking surfaces essential functional requirements for all types of hammers.
- Handle made from high quality strong wood and fixed firmly to hammer head, which does not come out even after long rough use.
- Generally Conforming to IS 841-1983



PRODUCT NO.	WEGHT		HANDLE LENGTH	
	Lbs	Kgs.	inch	mm
DSH-2/W	2	0.9	10.5	260
DSH-3/W	3	1.35	11	275
DSH-4/W	4	1.8	13	325
DSH-6/W	6	2.7	15	375
DSH-8/W	8	3.6	24	600
DSH-10/W	10	4.5	24	600
DSH-12/W	12	5.4	30	750
DSH-14/W	14	6.3	30	750
DSH-16/W	16	7.2	36	900
DSH-18/W	18	8.1	36	900
DSH-20/W	20	9	36	900

## 70 SLEDGE HAMMERS WITH FIBERGLASS HANDLE

- Drop forged from high-grade carbon steel.
- Partially Hardened up to 55 – 58 HRC on Striking surfaces essential functional requirements for all types of hammers.
- Painted to provide anti-rusting properties
- Available in Fiberglass Handle. Handle fixed firmly to hammer head ensures Durabilit



PRODUCT NO.	WEGHT		HANDLE LENGTH	
	Lbs	Kgs.	inch	mm
DSH-2/F	2	0.9	11	260
DSH-3/F	3	1.35	12	300
DSH-4/F	4	1.8	16	400
DSH-6/F	6	2.7	24	600
DSH-8/F	8	3.6	24	600
DSH-10/F	10	4.5	24	600
DSH-12/F	12	5.4	36	900
DSH-14/F	14	6.3	36	900
DSH-16/F	16	7.2	36	900
DSH-18/F	18	8.1	36	900
DSH-20/F	20	9	36	900



## 71 SOFT FACED PLASTIC HAMMERS

- Soft face hammers or mallets are most commonly used in applications where driving force is required without damaging the struck surface.
- Heads are made of transparent red high quality plastic & are replaceable.
- Generally Conforming to IS 10838-1984



Order Code	Mallet Dia (mm)	Inner Packing	Cartoon Packing
DPH-20	20	6	100
DPH-25	25	4	100
DPH-30	30	4	60
DPH-40	40	4	60
DPH-50	50	4	36

SPARE TIPS FOR PLASTIC HAMMER			
Order Code	Mallet Dia (mm)	Inner Packing	Cartoon Packing
DPT-20	20	10	300
DPT-25	25	10	300
DPT-30	30	10	300
DPT-40	40	10	200
DPT-50	50	10	200

## 72 BENCH VICE HEAVY DUTY

- Manufactured for high quality grey iron castings strong durable material
- Steel Jaw are hardened  $45\pm 5$  HRC for longer life Black Phosphate for corrosion protection
- Perfectly machined for smooth trouble-free operation ease of use for operator
- Sturdy SG Iron nut locked in the body provides accurate alignment between body & the jaws



Product No.	Jaw Width mm	Jaw Opening mm	Weight Kgs.	Box Packing
BVM/F/075	75	100	5.5	6
BVM/F/100	100	125	10	4
BVM/F/125	125	150	14	3
BVM/F/150	150	175	18.5	2
BVM/F/200	200	200	31	1

## 73 ENGINEERS STEEL VICE, STRAIGHT JAWS

- With an all steel construction, these fixed base vices are built to withstand the shocks of hammering, chipping and other tough applications
- Each vice has an integrated anvil for shaping and beating together with an extra heavy-duty-sliding jaw and large diameter screw
- Forged tommy bar along with the steel man screw helps in effective transmission of pressure on the work piece
- Carbon Steel jaws are hardened  $50\pm 5$  HRC to withstand tough use and are serrated for non-slip grip
- Safety stopper provided at the end of slide prevents slide from fall during usage.



Product No.	Jaw Width mm	Jaw Opening mm	Weight Kgs.	Box Packing
ESV/S/100	100	125	6.8	2
ESV/S/125	125	150	12.3	2
ESV/S/150	150	175	20	1
ESV/S/200	200	200	38.5	1

## 74 HYDRAULLIC BOTTLE JACKS

- The Jacks work in accordance with the Hydraulic Principle.
- Used for Lifting, Bracing, Shoving, Pushing & Spreading requirements, widely used in machinery, construction, automobile industry, vehicle repair etc.
- Heavy Duty Steel Saddle Secure Lifts, wide base design for stability & strength. Polished Ram provides durable performance.
- Hydraulic oil by-pass system prevents Ram from being over extended.
- Ideal for Passenger cars, pick-up Vans, Trucks, Heavy Duty Trucks, Agriculture, Mining & Marine applications.



Product No.	Capacity	LIFT RANGE (mm)		Cartoon Packing
		Min Height	Max Height	
DBJ-02W	2 Ton	148	278	10
DBJ-04W	4 Ton	180	350	5
DBJ-06W	6 Ton	195	380	5
DBJ-08W	8 Ton	195	380	4
DB-10W	10 Ton	200	385	4
DBJ-12W	12 Ton	200	385	4
DBJ-16W	16 Ton	210	395	2
DBJ-20W	20 Ton	235	440	2
DBJ-32W	32 Ton	285	435	2
DBJ-50W	50 Ton	285	435	1

## 75 HYDRUALLIC TROLLEY JACK

- The Jacks work in accordance with the Hydraulic Principle
- Steel hydraulic block assembly Includes dust seals to prevent oil contamination
- Easy access valve release



Product No.	CAPACITY	LIFT RANGE mm		Cartoon Packing
		Min Height	Max Height	
DTJ-02W	2 Ton	135	278	1

## 76 TOOL CABINETS

- Made from Robust High Quality Steel with inner walls, all cabinets finished with rust resistant powder coat paint.
- Fully opening drawers with ball bearing slides & liners gives smooth action even under load.
- Single Operation Locking System with cylinder locks for added security.
- Non Slip Eva Top Mat prevents scratches & protect tools.
- Durable Side handle enables easy movement of Cabinet.
- 100mm Heavy duty castors with 2xlocks provides better safety & can support heavy loads.



Order Code	Color	No. of Drawers	Overall Dimensions (L x W x H)	Weight
D24/3Y	Yellow	3	650x450x960mm	42kg
D24/3R	Red			
D24/5Y	Yellow	5	650x450x960mm	60kg
D24/5R	Red			
D24/6Y	Yellow	6	650x450x960mm	66kg
D24/6R	Red			
D24/7Y	Yellow	7	650x450x960mm	70kg
D24/7R	Red			

## 77 TOOL BOX CANTILEVER

- Made from robust high quality steel
- Premium yellow black powder coating finish for rust Protection & very attractive looks
- Precise & accurate riveting ensure smooth movement of trays for ease of use
- Available is variable selection of sizes & variants



Order Code	Dimensions (L x W x H)	Inner Packing	Cartoon Packing
D33-16	350x150x100	1	10

## 78 TOOL BOX CANTILEVER

- Made from robust high quality steel
- Premium yellow black powder coating finish for rust Protection & very attractive looks
- Precise & accurate riveting ensure smooth movement of trays for ease of use
- Available is variable selection of sizes & variants



Order Code	Dimensions (L x W x H)	No. of Trays	Inner Packing	Cartoon Packing
D33-17/3	425x200x150 mm	3	1	6
D33-17/5	425x200x200 mm	5	1	4
D33-21/5	525x200x200 mm	5	1	4

## 79 HAND TOOL KIT 15 PCS SET

- Tools Kit 15 pcs set ideal for home & DIY use.
- Supplied in BMC Box.



Order Code	Set Name	Contents in Blow Case	Cartoon Packing
STK-9S	TOOL KIT 15 PCS SET	1pc Comb Plier 6" 1pc Adj Wrench 6" 1pc Claw Hammer 1pc Tape Measure 3mtr 1pc Bit Holder 10pcs Bits – PH1-PH2-PH2-PH3- SL6-SL7-H5-H6-T15-T20	10 Sets

## 80 HAND TOOL KIT 126 PCS SET

- Tools Kit 126 pcs set ideal for Mechanics, Technicians, Household use & all kind of installation work.
- Supplied in BMC Box



Order Code	Set Name	Contents in Blow Case	Cartoon Packing
HTK-126	TOOL KIT 126PCS SET	1pc Comb Plier 6", 1pc Nose Plir 6" 1pc Adj Wrench 6", 1pc Claw Hammer 1pc Tape Measure 3mtr 8pcs Hex Key – 1.5 to 6mm, 1pc Torch, 1pc Knife 10pcs Bits – PH1,2,3 SL5,6 H5,6 T15,20, AD 8pcs Sockets 1/4" 5-13mm, 1pc Tester 2pcs Precision Screwdriver – Ph0, SL1.6 2pcs Screwdriver – SL6x100, Ph2x100 1pc Mini Hacksaw, 3pcs Saw Blades 1pc Wire Harness, 81Pcs Assorted Fastners	10 Sets

## CONVERSION CHART OF METRIC, SAE & WHIT WORTH SIZES

SAE	MM
1/4	6.35
5/6	7.94
11/32	8.73
3/8	9.52
13/32	10.32
7/16	11.11
1/2	12.7
9/16	14.29
19/32	15.08
5/8	15.88
11/16	17.46
3/4	19.05
25/32	19.84
13/16	20.64
7/8	22.22
15/16	23.81
1	25.40
1.1/16	26.99
1.1/8	28.57
1.3/16	30.16
1.14	31.75
1.5/16	33.34
1.3/8	34.92
1.7/16	36.51
1.1/2	38.10
1.9/16	39.69
1.5/8	41.28
1.11/16	42.86
1.3/4	44.45
1.13/16	46.04
1.7/8	47.72
2	50.80

WW	MM
1/16	6.50
3/32	7.54
1/8	8.64
3/16	11.30
1/4	13.33
5/16	15.24
3/8	18.03
7/16	20.83
1/2	23.37
9/16	25.65
5/8	27.94
11/16	30.48
3/4	33.00
13/16	35.30
7/8	37.59
15/16	40.13
1	42.42
1.1/8	47.24
1.1/4	52.07
1.3/8	56.39
1.1/2	61.21
1.5/8	65.53
1.3/4	70.10

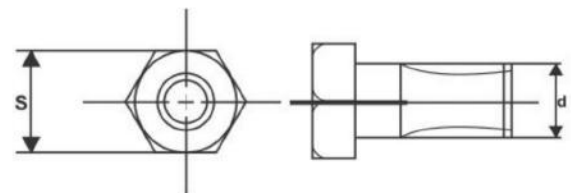

- **SAE** : SAE is the abbreviation of society of Automotive Engineers (USA) 1/2 means 1/2" distance across flats of bolts, screw heads & nuts.
- **MM** : In case of mm, the distance across flats is indicated in millimeters, 12 mm means 12 millimeters distance across flats of bolts, screw heads & nuts.
- **WW** : ww is the abbreviation for whitworth (U.K.) and it indicates diameter of the bolts or screw, 1/8ww means diameter of the bolts as 1/8" & does not indicate distance across flats



**DURELO**  
TOUGHEST TOOLS



# TOOLS & EQUIPMENTS

## CONTACT US



india@durelotools.com



0129-4014030



www.durelotools.com



DURELO TOOLS & EQUIPMENTS PVT. LTD.  
66/6, N.I.T Industrial Area,  
Faridabad - 121002, Haryana (INDIA)